

Video Wall Management

Virtual Spectator Audio

- Turn on or off the virtual spectator audio

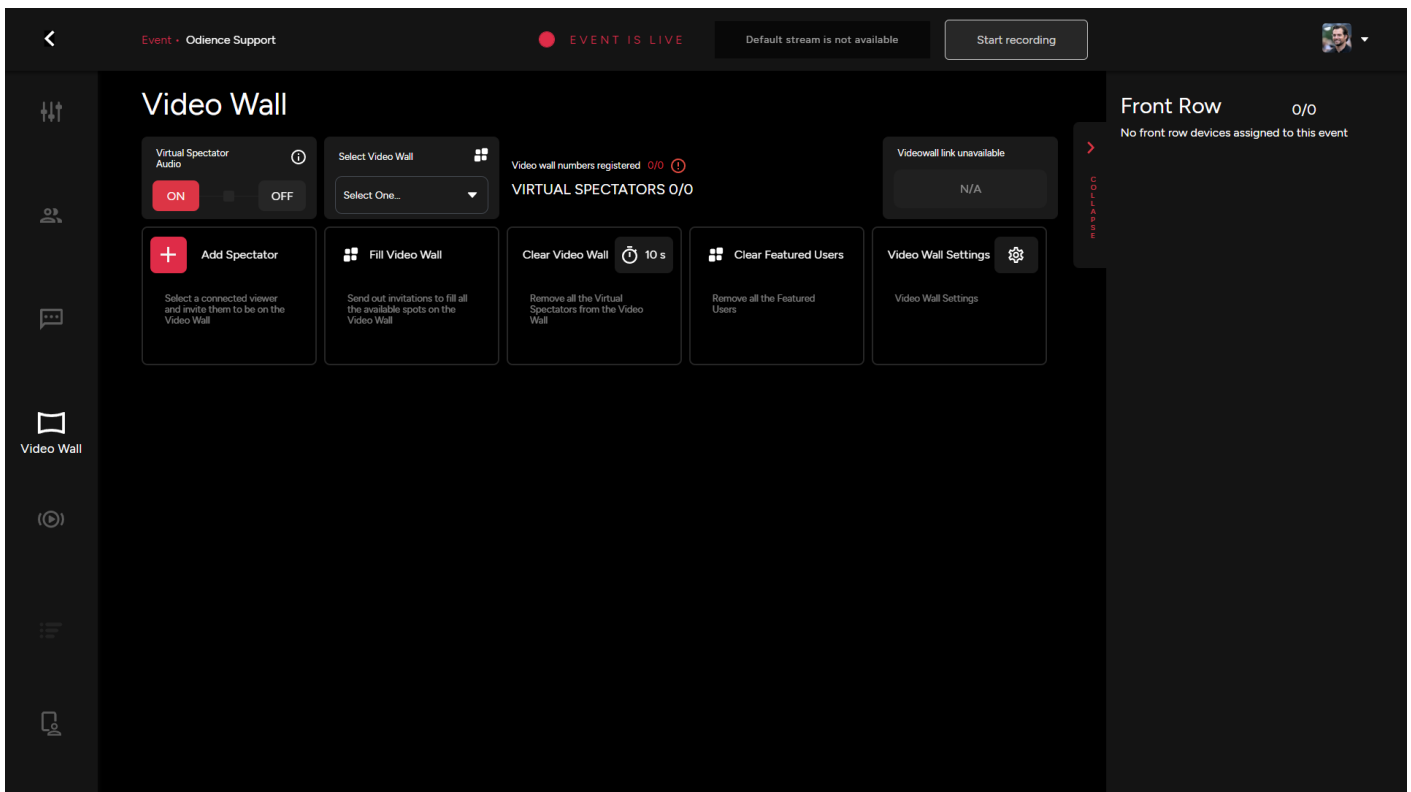

Add Spectator

- Select a connected viewer and invite them to be on the Video Wall

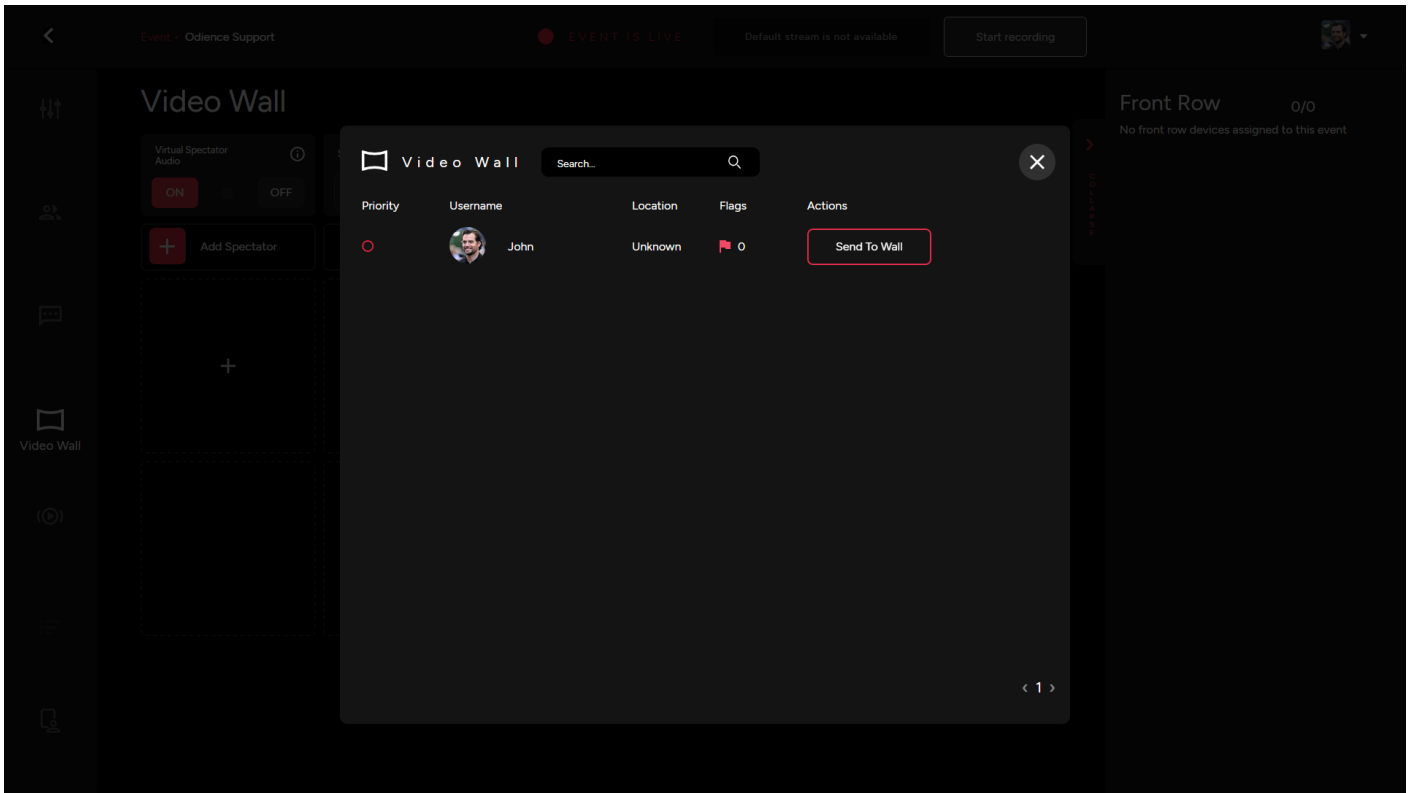

Fill Video Wall

- Quick access to remove all the virtual spectators from the video wall

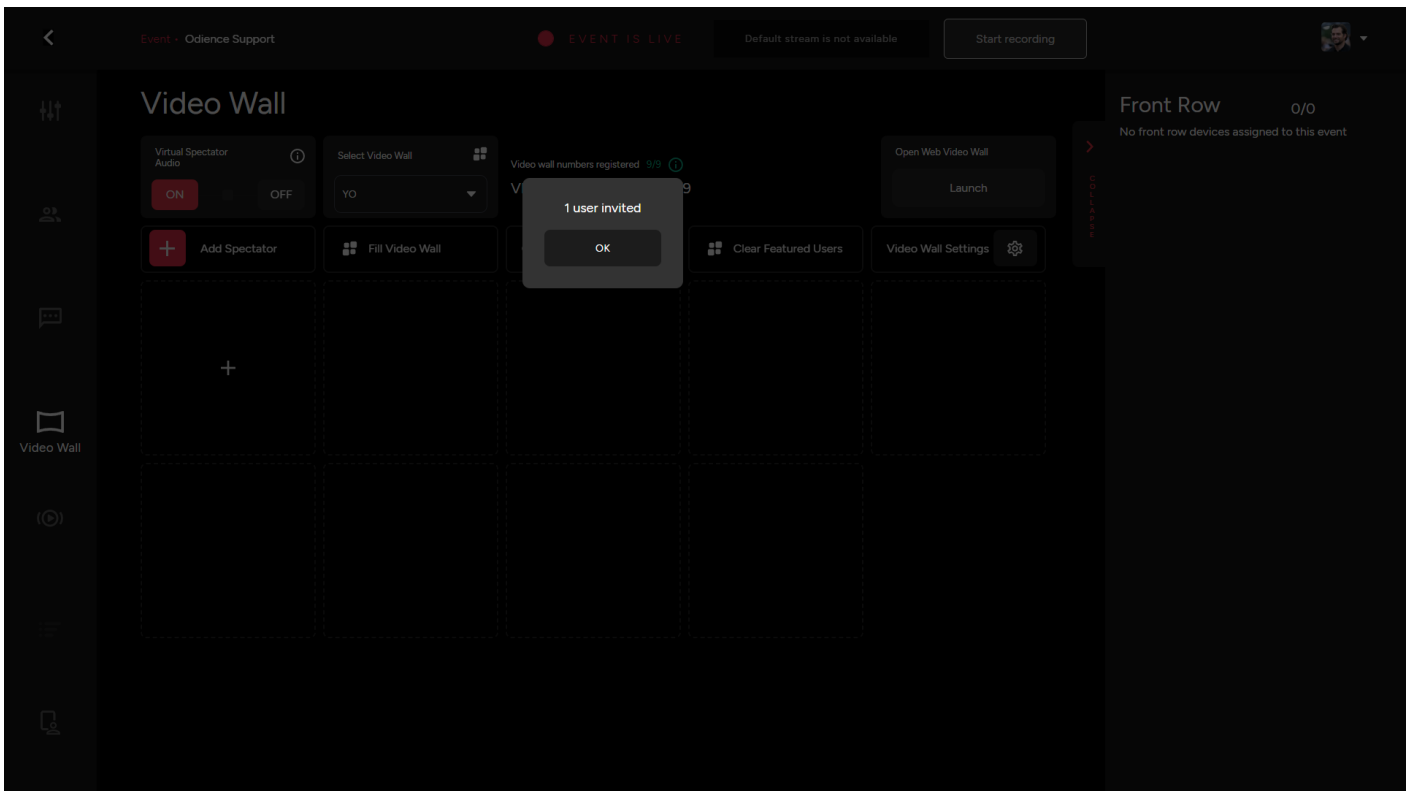

Clear Video Wall & Set End Call Timer

- Remove all the Virtual Spectators from the video with the click of a button. Set a Call Time, this will only be used when ending a call for a single spectator.

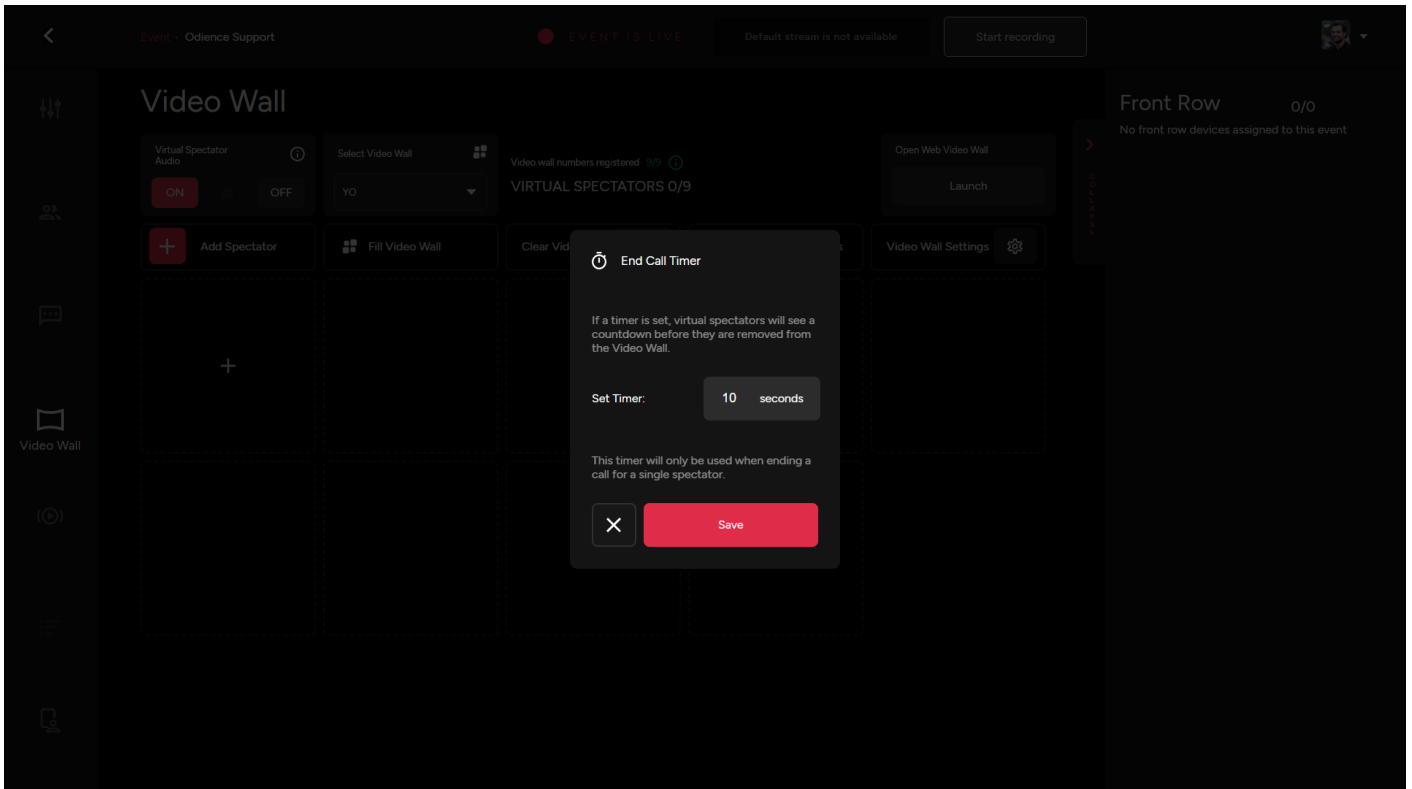

Clear Featured Users

- Remove all the Featured Users with the click of a button

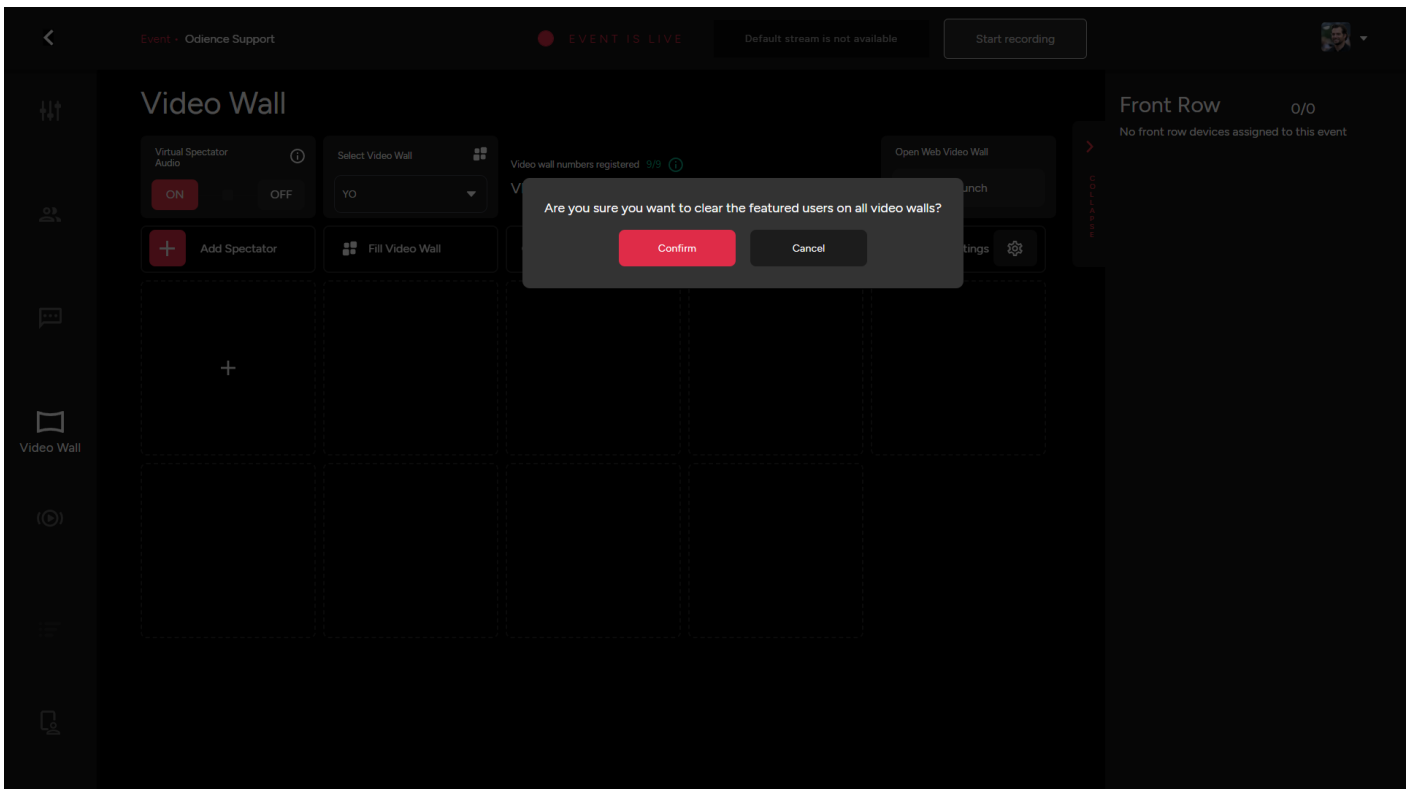

Video Wall Settings

- Set the amount of time a connected viewer will have to accept an invitation before it disappears. Set video resolution, we support from SD 640x480 all the way to FHD 1920x1080.

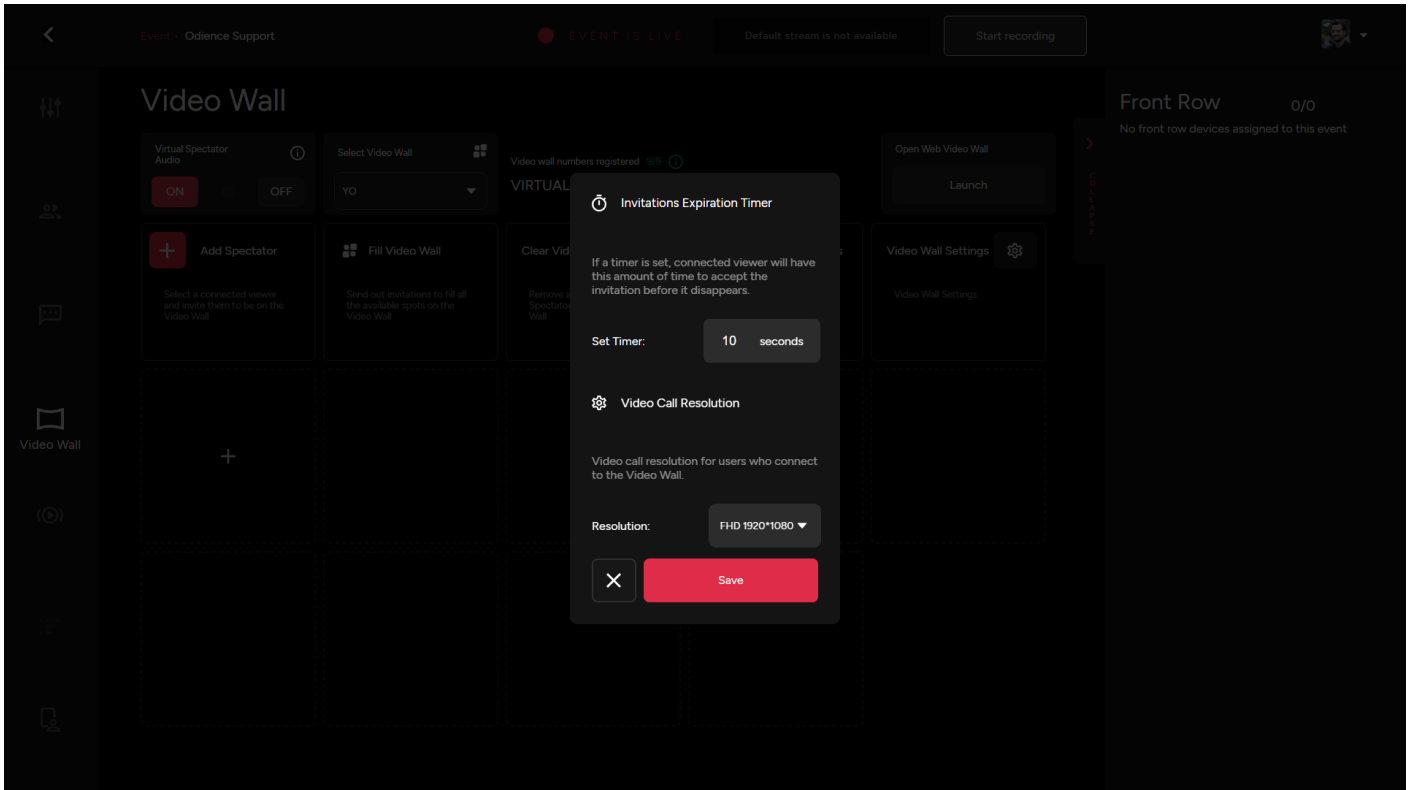

Video Wall Link

- Launch Web Video Wall from this section.

Note: Will include sample of Web Video Wall when it starts working.

Front Row

- TBA

Revision #5

Created 11 March 2024 14:56:42 by Admin

Updated 13 March 2024 20:59:41 by Admin